

## NOTES TO PARENTS

"My First Scalextric" sets have track, cars and hand controls colour coded to make it easier for the young "driver" to decide which controller and which track lane to use for each of the cars. This eliminates any confusion when starting a race and, more importantly, when a car has to be replaced on the track during a race. Adult assistance will be required to set up the race track for very young drivers. Read right through these instructions before starting to assemble the race track.

## RACING INSTRUCTIONS

- Speed of the car is controlled by the hand controller trigger. The more you squeeze the trigger the faster the car will go.
- Slow down for the bends by releasing the trigger. • If the car is going too fast on the bend it will fly off the track.
- The hand throttle is set to full speed by default. This can be adjusted (see figure 6 over the page).

## SAFETY NOTES

- This product is not suitable for children under 3 years of age because of small parts which can present a choking hazard. Some components have functional sharp edges – handle with care.
- This product is intended for indoor use only.
- Requires 4 x D Batteries. • Alkaline batteries recommended. • Do not use rechargeable batteries.
- Non-rechargeable batteries are not to be recharged.
- Different types of batteries, or new and used batteries are not to be mixed.
- Only Batteries of the same or equivalent type as recommended are to be used. • Batteries should be replaced by an adult.
- Batteries are to be inserted with the correct polarity, as indicated in the battery box.

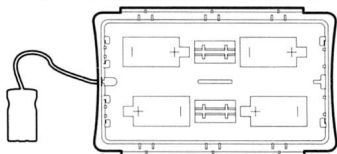

- Exhausted batteries are to be removed from the product. • The supply terminals are not to be short-circuited.
- Batteries are to be removed from the product when not in use. • Do not dispose of batteries in fire.
- This must not be connected to a mains power supply.
- Use only as indicated in the instructions. Do not modify or change any part of the set. Modification may damage the set and will invalidate the warranty claim. Use only genuine Scalextric spares and accessories available from your retailer or [www.scalextric.com](http://www.scalextric.com).
- When new, hand controllers may become warm, emit vapour and give off a slight smell. These effects are normal due to the protective coating on internal parts and will disappear after use. However, they may return if the trigger is held continuously in a fixed position while racing.
- Before cleaning any part, disconnect the battery box. **Do not use liquid for cleaning.**
- Please retain these details and address for future reference.

## HORNBY SERVICE WARRANTY

Hornby products are guaranteed against defects in materials or workmanship for a period of six months from purchase.

If any such defect occurs during the period of warranty, please contact a Scalextric dealer for assistance.

A full list of service dealers can be found on [www.SCALEXTRIC.com](http://www.SCALEXTRIC.com)

Alternatively, the product (or component), may be forwarded to Hornby Hobbies Limited, carefully packed, with a note enclosed giving full details to:

Repairs Department, Hornby Hobbies Limited, Westwood, MARGATE, Kent CT9 4JX

The product will be repaired or replaced, free of charge, if the problem is found to be due to either workmanship or materials.

This warranty is valid for products purchased in the United Kingdom and is in addition to, and does not diminish, your statutory rights.



Waste electrical products should not be disposed of with household waste. Please recycle where facilities exist. Check with your Local Authority or retailer for recycling advice.

## BATTERY RECYCLING INFORMATION

Help the environment by disposing of batteries responsibly. The wheeled bin symbol indicates that batteries must not be disposed of in domestic waste as they contain substances which can be damaging to the environment and health. Please remove exhausted batteries from the product and use designated collection points or recycling facilities when disposing of batteries.

## Helpline

Telephone: 01843 233525  
email: [customer care@hornby.com](mailto:customer care@hornby.com)

Fax: 01843 233527  
[www.scalextric.com](http://www.scalextric.com)

# CONTENTS

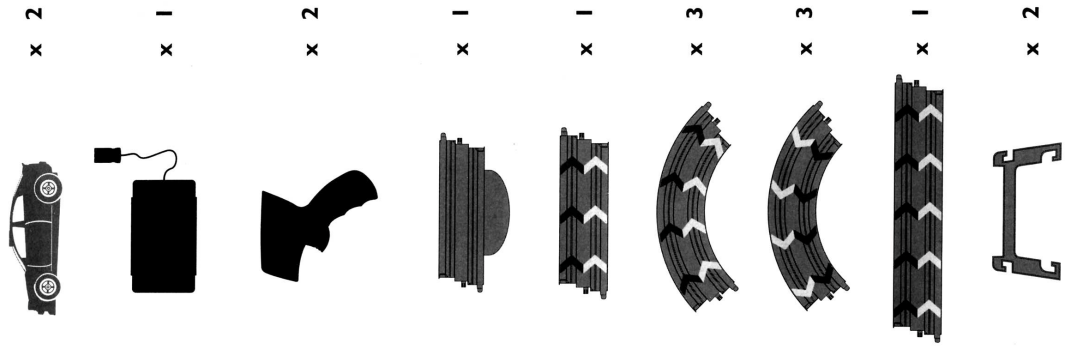

x 2  
x 1  
x 2  
x 1  
x 1  
x 3  
x 3  
x 1  
x 2

	Guide Blade Plate	x 2
	Braids	x 4
	Spare Part No.W1573	

**FAULT FINDING**

- Body comes off after crash – refit by lining up the clips on the body and chassis and push to close.
- Cars do not run – the braids may need cleaning or bending out towards the track or changing, see overleaf.

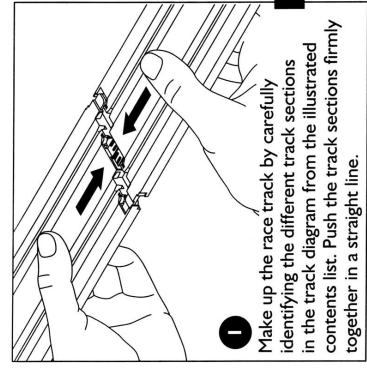

**1** Make up the race track by carefully identifying the different track sections in the track diagram from the illustrated contents list. Push the track sections firmly together in a straight line.

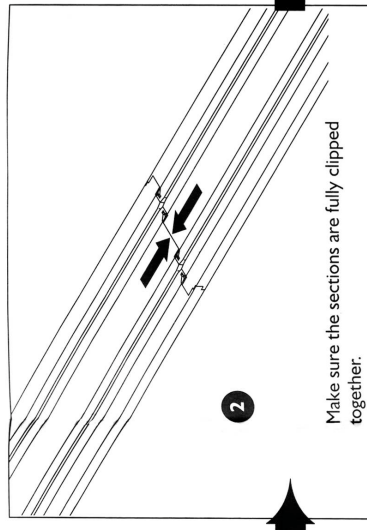

**2** Make sure the sections are fully clipped together.

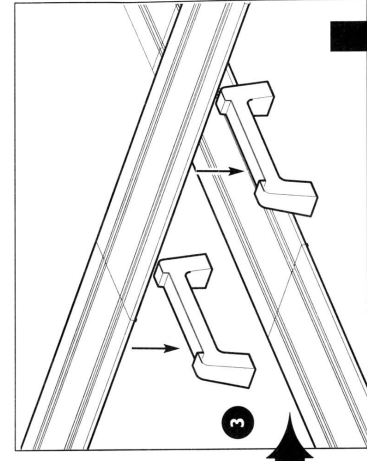

**3**

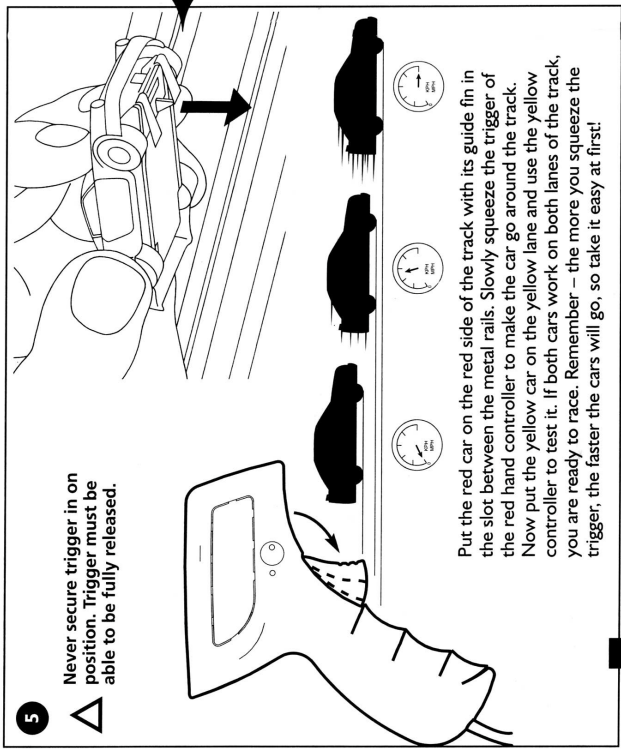

**5** Never secure trigger in on position. Trigger must be able to be fully released.

Put the red car on the red side of the track with its guide fin in the slot between the metal rails. Slowly squeeze the trigger of the red hand controller to make the car go around the track. Now put the yellow car on the yellow lane and use the yellow controller to test it. If both cars work on both lanes of the track, you are ready to race. Remember – the more you squeeze the trigger, the faster the cars will go, so take it easy at first!

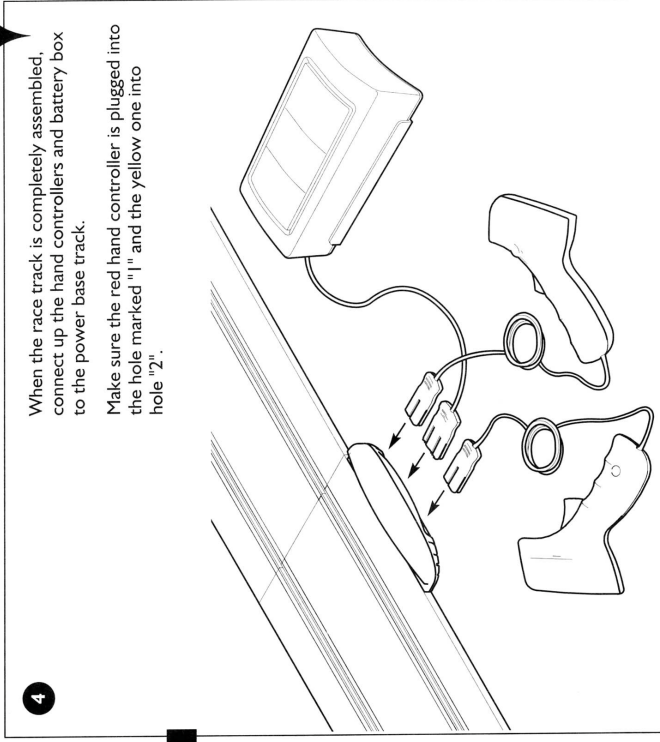

**4**

When the race track is completely assembled, connect up the hand controllers and battery box to the power base track.  
Make sure the red hand controller is plugged into the hole marked "1" and the yellow one into hole "2".

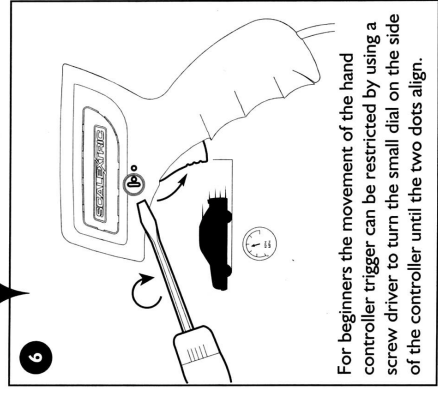

**6**

For beginners the movement of the hand controller trigger can be restricted by using a screw driver to turn the small dial on the side of the controller until the two dots align.

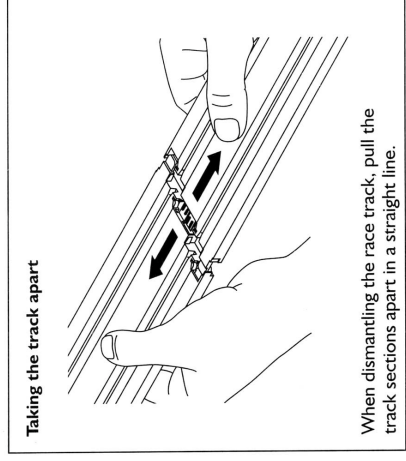
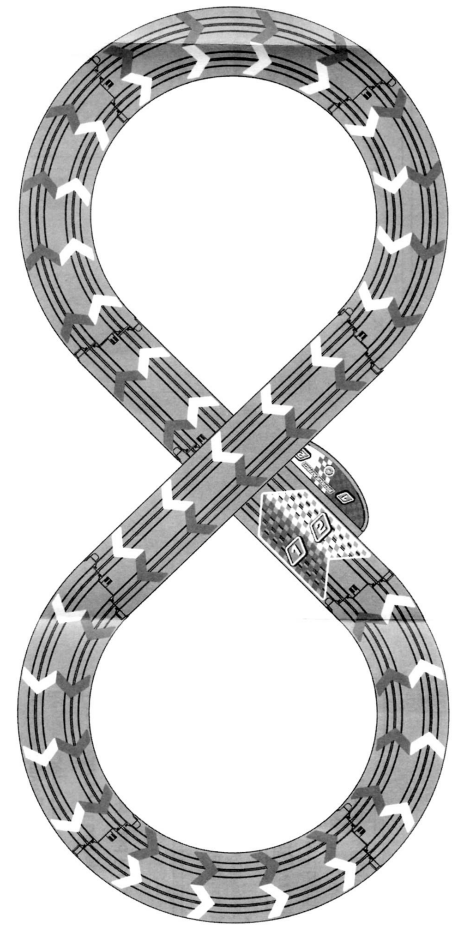

Taking the track apart

When dismantling the race track, pull the track sections apart in a straight line.

# CHANGING THE BRAIDS & CAR MAINTENANCE

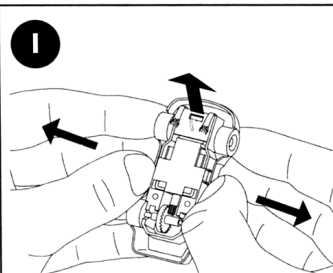

After a while, the pick-up braids underneath the cars may become worn out and need replacing. To do this, turn the car over and unclip the body from the chassis.

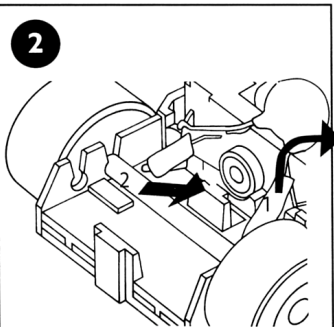

Carefully bend the orange/brown capacitor back to reveal the guide blade clip. Unclip the rear of the guide blade by pressing BACK & DOWN on the clip from the inside of the chassis with a SCREWDRIVER.

- 1 Bend capacitor up to reveal clip.
- 2 Push back down on clip with a screwdriver.

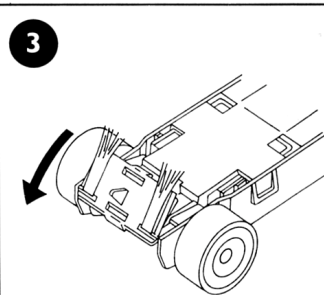

Turn the chassis over and remove the braid plate from its front clip.

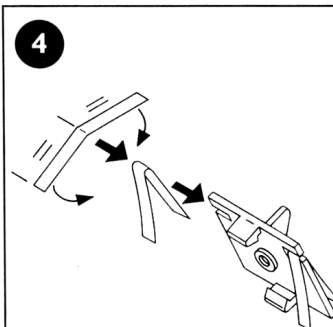

Fit new braids to replacement guide plate. The braids should be folded so that the ends on top of the guide plate are 10mm long.

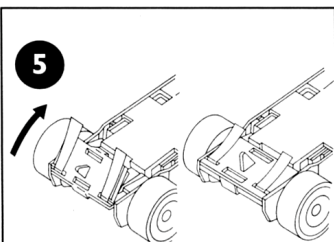

Fit the assembled guide plate assembly on to the chassis by engaging the front clip first and then the rear clip.

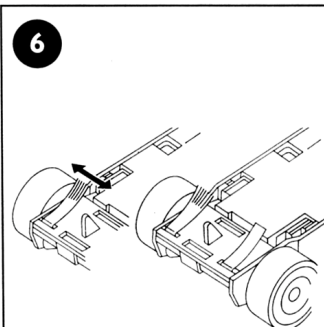

Refit the car body and tease out the ends of the braids so they make good contact with the pick-up rails in the track.

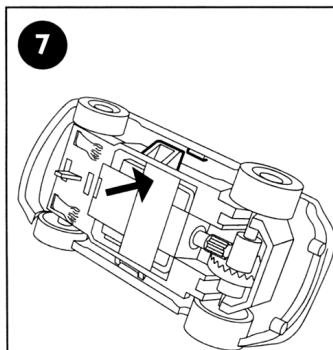

To refit the body to the chassis, clip one side in first followed by the other.

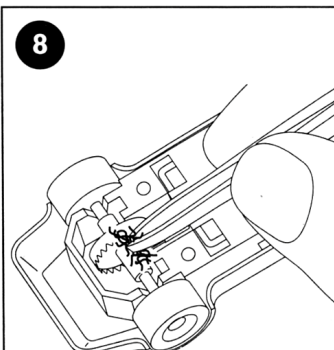

Remove any carpet fibres, pet hairs etc., from around the car's axles and gear wheel.

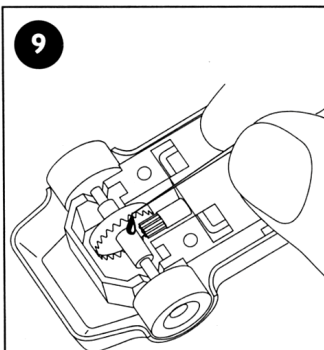

Periodically, oil the axle bearings and gear wheel with one drop of light machine oil.

## TRACK MAINTENANCE

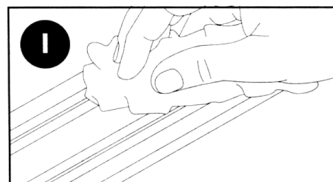

Always keep track clean by wiping over with a non-fluffy cloth, especially before putting the set away. Keep the pick-up rails shiny by rubbing carefully with a nylon "Scotch" washing-up pad or track cleaning rubber, reference R8087, obtainable from Hornby stockists.

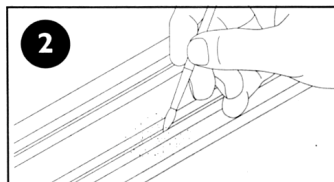

Keep the slot between the pick-up rails free from anything which would prevent the guide fin from travelling along it freely.

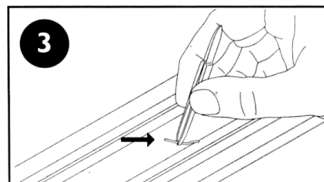

Make sure anything made of metal does not bridge the two pick-up rails which would cause a short-circuit.

Replacement braids and guide plates are available from [www.scalextric.com](http://www.scalextric.com)



**Guide Blade Plate** x 2



**Braids** x 4

**Spare Part No.G8029**