

WORLD CHAMPIONSHIP

RACING DRIVERS' & TRACK MARSHALLS' BRIEFING NOTES

Please read through these notes carefully and keep in a safe place for future reference.

Fig. 1

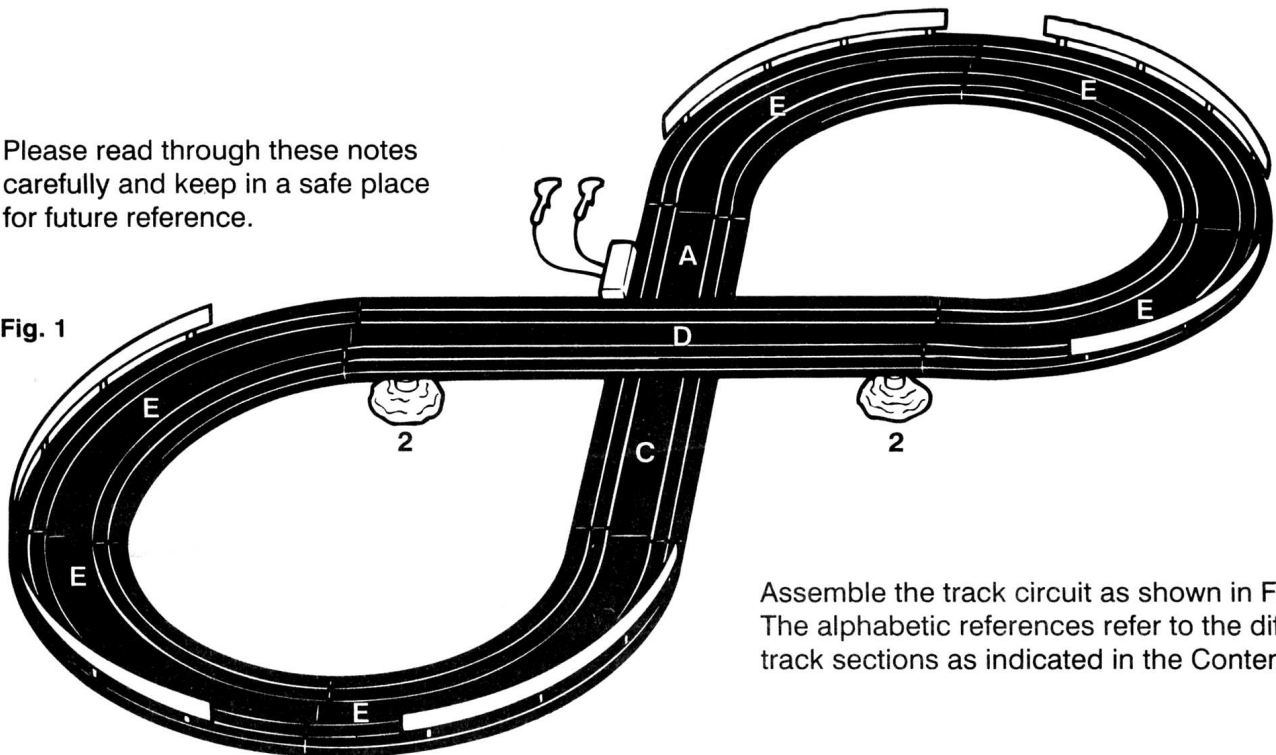

Assemble the track circuit as shown in Fig. 1. The alphabetic references refer to the different track sections as indicated in the Contents List.

Support the track at the positions and levels indicated in Fig. 1 with the Track Support components supplied (see Fig. 2).

Fit the crash barriers to the track at the places indicated in Fig. 1, referring to the instructions given in the general set leaflet.

Fig. 2

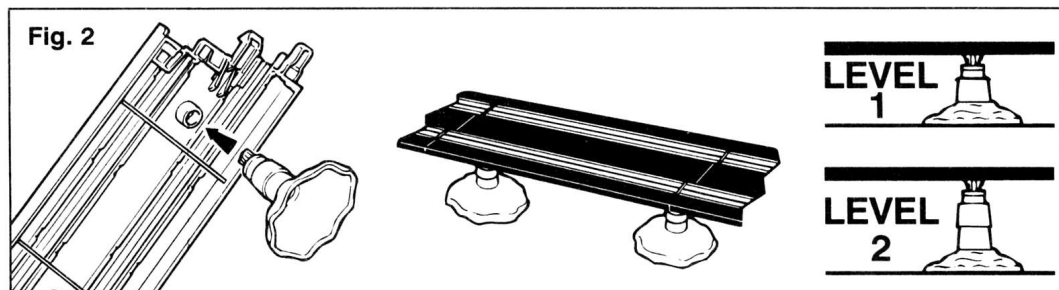

RUNNING TIPS

- Make sure that all joints between track sections are made correctly so that power gets through, and that there is nothing to restrict the passage of the car's guide blade travelling along the slot between the metal rails.
- Remember that you can drive fast up to the bends, ease off while in the bend and accelerate to drive fast out of the bends.

CONTENTS

1 x G078	Benetton Formula 1 car*	1 x G101	382mm (15") straight track (D)
1 x G079	Ferrari Formula 1 car	2 x L7556	Track Support Base
1 x C180	Hand Throttle, yellow	4 x L7557	Track Support Spacer
1 x C183	Hand Throttle, blue	2 x L7558	Track Support Plug
1 x C912	Wall-mounted Power Unit	6 x L7559	Crash Barriers
1 x G107	Power Base Track (A)	1 x W1502	Braid and Guide Pin pack
6 x G105	300mm (12") curved track (E)	1 x 4/733E	Drivers' and Marshalls' Briefing Notes
1 x G103	153mm (6") straight track (C)	1 x 4/729B	General Micro set instruction leaflet
		1 x 4/805	Service Dealer leaflet



DRIVING AND RACING HINTS 'n' TIPS



MicroScalextric cars, like their full size counterparts, require a level of skill to drive them at their best.

- Start slowly for the first few practise laps, exactly like the very best Formula One drivers.
- Accelerate and slow down smoothly. If you accelerate too fast, you will see a lot of spectacular crashes, but you will also lose most of the races.
- Go fast down the straights, slowing down as you enter the corners and accelerate as you come out of them. Take it easy over bridges and flyovers

- Watch your car as you are driving. You will learn to leave your braking to the last second as you approach a bend.

Before asking for help or service, please read the instructions through carefully.

Most operating difficulties can be easily rectified by making a small adjustment to the braid or simply cleaning the affected part.

The most common cause of a malfunction will be a worn braid. Also, poor running may be caused by fluff or hair trapped around the moving parts. This may be easily removed with a brush or tweezers.



FAULT-FINDING GUIDE



PROBLEM	CAUSE	ACTION
Cars will not run	<ul style="list-style-type: none"> ● Power Pack not turned on. ● Guide pin not located in track slot. ● Braid not making contact with track ● Dirty Braid. ● Dirty Track. ● 240V household outlet not working. ● Overload protector tripped due to short circuit or overheating. ● Faulty wall mounted Power Unit. ● Faulty Hand Throttle. ● Faulty Car. 	<ul style="list-style-type: none"> ● Turn on the power at the mains. ● Position the car with its guide pin in the slot between the metal rails. ● Bend braids slightly to make contact with the metal rails. ● Replace braid or guide pin assembly (see general set instruction leaflet). ● Wipe metal rails clean with a non-fluffy cloth – DO NOT USE SANDPAPER, OTHER ABRASIVE MATERIALS OR LIQUID. ● Change to another 240V outlet. ● Unplug the power unit, or switch off at the mains. After 60 seconds, the overload protector will reset and you can continue racing. Check the track and cars to ensure the cause of the short circuit has been removed. ● Replace Power Unit. IMPORTANT: NEVER ATTEMPT TO OPEN POWER PACK. ● Change hand throttle to other lane. If still not working, replace hand throttle. ● If after carrying out all of the above the cars still will not run, seek assistance from a Scalextric Service Dealer.
Cars run slowly or erratically	<ul style="list-style-type: none"> ● Dirty track. ● Dirty or worn braid. 	<ul style="list-style-type: none"> ● Wipe metal rails clean with a non-fluffy cloth. NEVER USE SANDPAPER, OTHER ABRASIVE MATERIALS OR LIQUID. ● Replace braid or guide pin assembly (see general set instruction leaflet).
Excessive crashes	<ul style="list-style-type: none"> ● Worn guide pin. ● Incorrect braid position. ● Poor driving technique 	<ul style="list-style-type: none"> ● Replace guide pin (see general set instruction leaflet). ● Flatten braid onto the chassis (see general set instruction leaflet). ● SLOW DOWN!



These instructions have been designed to aid you through the assembly of your newly purchased MicroScalextric set. By following the assembly steps carefully you will be quickly racing. To enjoy continuous good racing it is very important to ensure regular track maintenance and that the vehicle pick-up braids are kept in good order. This can be achieved very easily by using a set of small screwdrivers, a non-fluffy cloth, emery board and a coin. See section on "Keep Your Track Clean Too!" and "A Clean Car Wins the Race".

INTRODUCTION – A GAME OF SKILL

Congratulations and welcome to the motor racing world of MicroScalextric. Just like the real thing, MicroScalextric racing is a game of skill and judgement and just like the real thing, a little practice is necessary before you will be able to take corners at speed and receive the chequered flag. To allow you to obtain the maximum racing pleasure from your MicroScalextric please remember the following rules:

- Squeezing the throttle varies the speed of the car.
- Practice "driving" the car around the track.
- You will notice that just like the real thing, the car will come off the track if driven too fast when cornering. To avoid this you must vary the speed as you travel around the circuit. For tips on how to do this refer to the separate leaflet entitled "RACING DRIVERS' & TRACK MARSHALLS' BRIEFING NOTES".

As your practicing builds up your confidence you will be able to take the corners at speed and you will quickly develop your own technique for this.

Above all, remember to take your time and learn your craft, as all top racing drivers do.

SETTING UP THE LAYOUT

Assembling your MicroScalextric layout is simplicity itself, providing you follow the step by step instructions. Taking your time will pay dividends. A little time spent carefully assembling the layout should prevent any delays or false starts!

STEP 1

Check to see if you have all the components which are listed under CONTENTS LIST on the "RACING DRIVERS' & TRACK MARSHALLS' BRIEFING NOTES".

STEP 2

Carefully study the track diagram shown on the Briefing Notes.

STEP 3

You can now start to assemble your circuit.
Keep the Briefing Notes open and refer to the track layout illustration. Carefully push the track together and snap into place (diagram 1 below). Make sure all the metal rail ends are firmly in contact with the rail in the adjoining track section. This will ensure good electrical contact.

1

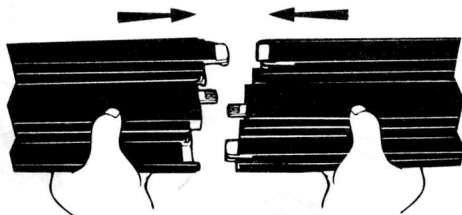

2

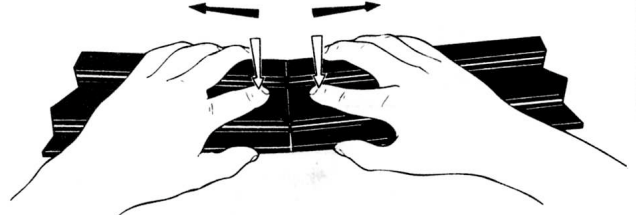

STEP 4

Continue to assemble the track using the layout diagram shown in the Racing Drivers' & Track Marshalls' Notes. If the contents of your new set are capable of creating alternative layouts, then study the track diagrams shown and choose the one marked "Level One". This circuit will allow you to develop your skills and once mastered you will be able to move onto the more advanced circuits with the addition of extra track.

To dismantle the track, press between the sets of metal rails and pull apart (diagram 2 above).

CRASH BARRIERS

STEP 5 Refer to the Marshalls' Notes for positioning of the crash barriers. For fitting to the track see Diagram 3.

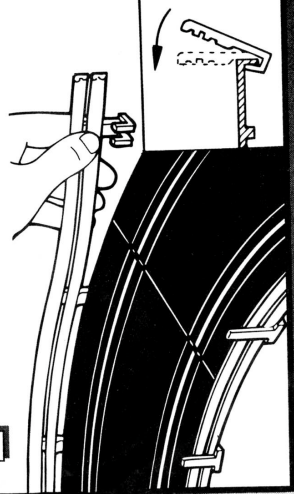

HOOKING UP THE POWER

STEP 6 To connect power to the track follow the instructions as in Diagram 4.
IMPORTANT: ALWAYS REMOVE THE POWER PACK FROM THE WALL SOCKET WHEN NOT IN USE.

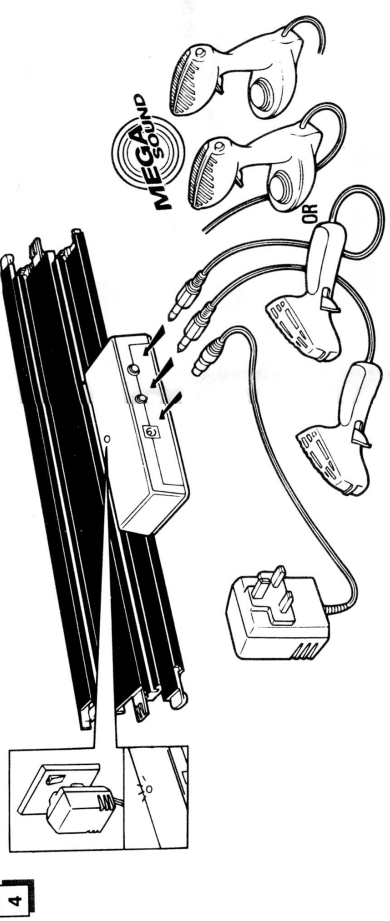

NEARLY READY - NOW, THE CARS ...

STEP 7 Place the cars onto the track ensuring that the guide pins go into the slots (Diagram 5). Spare braids and guide pins are included just in case you need them later. Please keep them safe. Should you require further replacements please quote W1502 when obtaining them from your local stockist or Service Dealer.

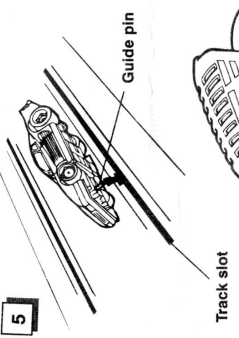

... AND YOU'RE OFF!

STEP 8 Each driver grips a hand throttle and squeezes the trigger. (Diagram 6).

This action speeds up the cars. To slow down release the trigger. Simple isn't it?

Now remember - **SLOW** around the **bends** and **FAST** on the **straights**.



A CLEAN CAR WINS THE RACE

STEP 9 BRAID AND GUIDE PIN MAINTENANCE

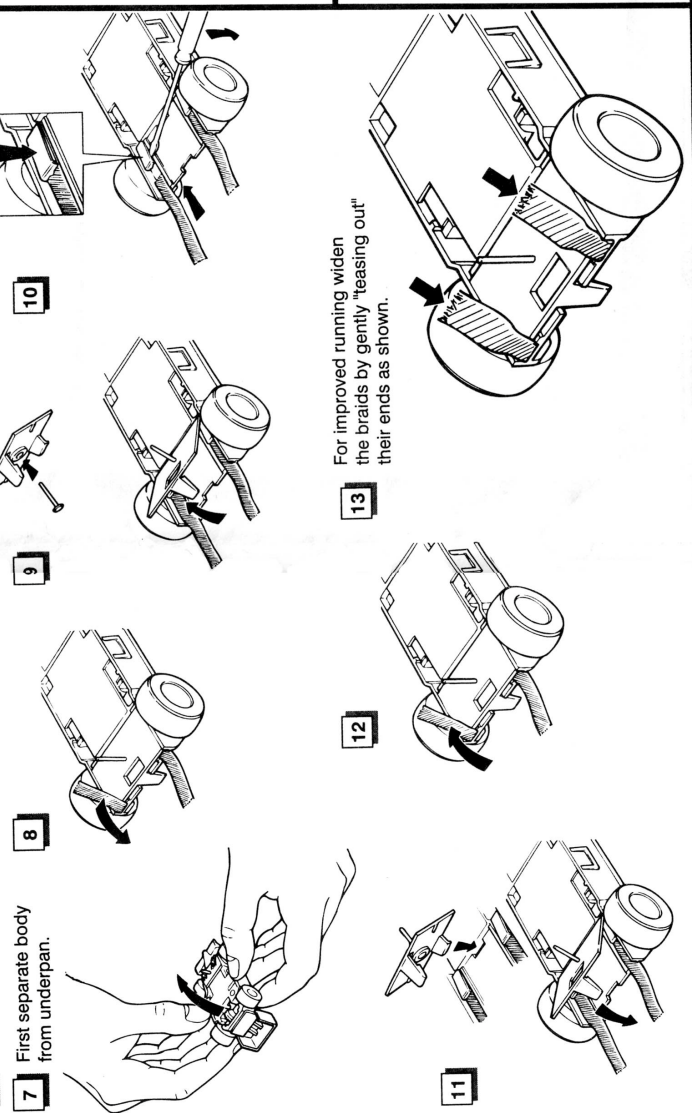

For improved running widen the braids by gently "teasing out" their ends as shown.

CLEANING AND LUBRICATION

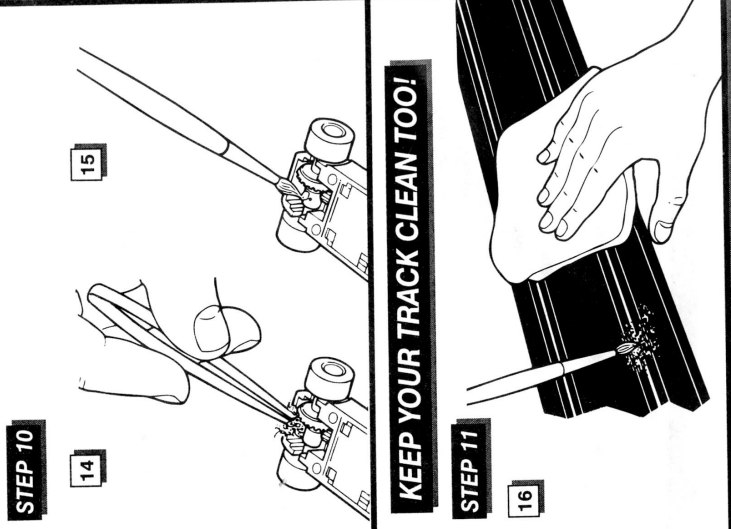

KEEP YOUR TRACK CLEAN TOO!

Steps 9, 10 and 11 Checklist

1. Keep the cars pick-up braids, which are located either side of the guide pin, in good condition (diagrams 7 to 13).
2. Check that carpet threads, pet hairs or fluff are not building up on the cars rear axle assembly. If this happens carefully remove with a pair of tweezers (diagram 14).
3. A certain amount of lubrication will also be periodically required on the rear axle gear (Diagram 15). Use a minute amount of light oil. DO NOT OVER OIL AS THIS WILL ONLY ATTRACT MORE FLUFF.
4. Clean your track after every racing session (diagram 16). Refer to the "Fault Finding Guide" in the DRIVERS' & MARSHALLS' NOTES on how to clean dirty track. NEVER USE ANY ABRASIVE MATERIALS OR LIQUIDS.
5. IMPORTANT: Always remove the Power Pack from the wall socket BEFORE cleaning track.

IMPORTANT NOTICE

Congratulations on receiving your new MicroScalextric racing set. To help ensure long lasting use of this road racing set, please care for your set by cleaning it regularly as shown in these instructions and by following the points below:

- Do not attempt to drag or push obstacles around the track with your car.
- Do not try to force obstacles off the track with your car.
- Do not "crash into" obstacles with great force.
- If something becomes stuck or "jammed" in the car, contact a Scalextric Service Dealer for advice.
- While operating the hand throttle, do not hold the car in a fixed position preventing the rear driving wheels from rotating. This will permanently damage the motor.

Any of the above may cause harm to your car and shorten the life of the set.

We hope you enjoy your new MicroScalextric racing set and that you have hours of fun.

NOTE TO PARENTS

WARNING! The Wall Mounted Transformer should be examined regularly for potential hazards such as damage to the casing, plug pins or output cable. In the event of any damage the toy must not be used until the damage is repaired or the unit replaced. The power pack is a "Transformer for Toys" and the toy must only be operated from the power pack provided or an identical replacement.

WARNING! If the electric motor in the vehicle is jammed, switch off the supply and allow the vehicle to cool. Do not touch the electric motor metal casing.

Hand throttles get warm in use and may give off a slight smell when new. This should cease after a while. If a hand throttle should start to overheat, it is being overloaded. In this case stop immediately. Correct the fault by checking the following.

- Two cars on the same track.
- A piece of metal on the track touching both conductor rails.
- Cars not running freely due to fluff or hairs in the gears.
- Rear wheel disengaged from chassis of car.

If a short circuit occurs, the wall-mounted power unit cut-out will operate. To reset, switch off at the mains, wait 60 seconds and switch back on.

If a car fails to run on a particular track section there may be faulty track connections. To correct, inspect track ends to ensure no excessive distortion of the metal rail sections has occurred. This can be easily rectified with a screwdriver, after turning off the power.

Disconnect the wall-mounted power pack from mains after use.

IMPORTANT: It is possible to test the transformer, hand throttles and cars without assembling the complete track.

Hook up power to the terminal track (see assembly instructions step 6) and test both hand throttles and cars.